

Billi Eco with Safety Dispenser

The opening stanza for the boiling & chilled range of drinking water appliances, the Billi Eco is the pioneer in space saving, energy efficient and environmentally conscious under-bench instantaneous systems. The high performing system is specifically designed for tight spaces, servicing smaller populations requiring fast recovery.

The Safety Dispenser was designed in consultation with industry experts and is widely regarded as the best fit-for-purpose solution currently available. Ideal for high security or critical care environments, including correctional facilities and mental health care units.



BOILING



CHILLED



Features



**AUSTRALIAN
DESIGNED
& MADE**



**SPACE SAVING
DESIGN**



**ECO-
INTELLIGENCE
TECHNOLOGY**



**ENERGY
EFFICIENT**



**EASY
INSTALLATION**



**ADJUSTABLE
CHILLED
TEMPERATURE**

Safety
Dispenser



Eco Under-Bench
Unit



Finishes

Standard Finish



CH - Chrome

Add the relevant Finish Code to the Product code to complete your specification eg 901000VCH-LF

Accessories

990718CH - QL Font for Safety dispenser



990720 - Tubing Extension Kit for X series dual temp dispensers 2mtrs

Product Specifications

| | |
|--------------------------|---------------------------------------------------------------------------------------------------------------------------------------------------------------------------------------------------------------------------------|
| Water Type | BC |
| Dispenser | V - Safety Dispenser |
| Mixer Tapware | N/A |
| Product Code | 901000V |
| Warranty | 3 years manufacturers warranty |
| Under-Bench Dimensions | 180mm(W) x 340mm (H) x 500mm (D) |
| Boiling Output | Up to 90 cups per hour |
| Chilled Output | Up to 60 cups per hour |
| Sparkling Output | N/A |
| 50°C Hot Water Output | N/A |
| Min / Max Dispenser Temp | 6°C / 99°C |
| Power Plug | 10 amp |
| Power Rating | 1600W, 220-240V, 50-60Hz |
| Water Pressure | Min. 250kPa |
| Ecolabel | N/A |
| EPD | N/A |
| Greenstar Contribution | N/A |
| Watermark License | WM-021525 |
| Lead Free | ✓ |
| Section J7.7 (NCC) | ✓ |
| WELS | N/A |
| WELL | Cornerstone Membership |
| Management Systems | Every Billi drinking water appliance is manufactured under the strictest standards and is certified in accordance with: ISO9001 for QMS (FS 790754), ISO14001 for EMS (EMS 801468) and ISO45001 for OSHS (OHS 801469). |
| Food Handling | HACCP - PE-138-BIL-R1-02 |
| Filtration | 994051 - 5.0 Micron supplied standard |

Scan the QR code access
our Revit families on

bimstore

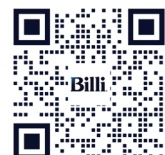

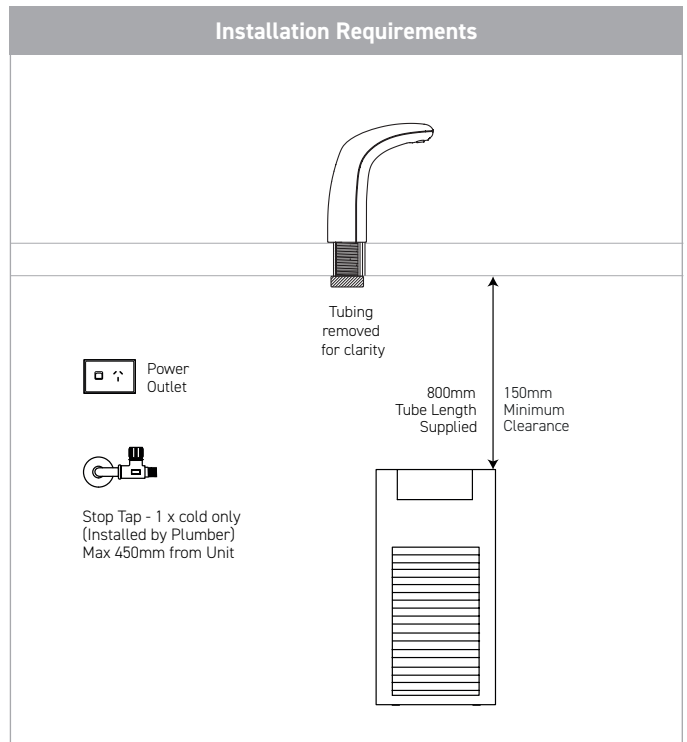
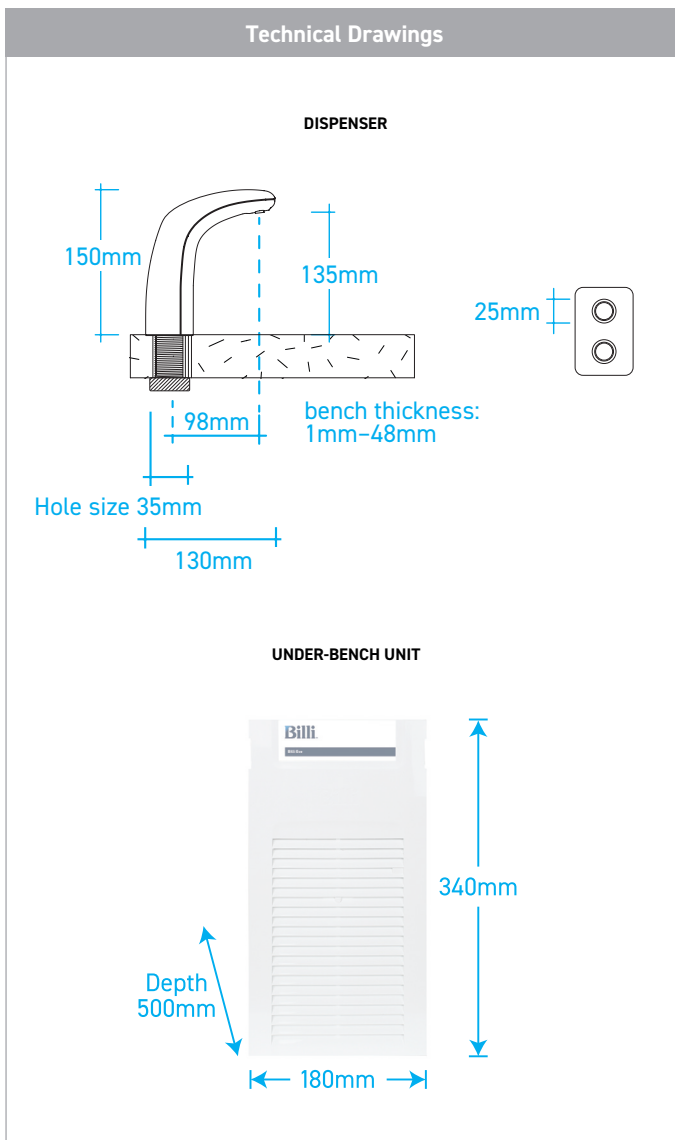

Installation Notes

| | |
|-----------------------|---------------------------------------------------------------------------------------------------------------------------------------------------------------------------------------------------------------------------------------------------------------------------------------------|
| Electrical | A standard 10 amp power outlet is required, located no further than 1000mm from the underbench unit. The system is supplied with a 1 metre flex cord and plug. |
| Water | A single 1/2" BSP (15mm) stop-tap with a male thread should be installed in an easily accessible position. Water supply must be microbiologically safe to drink, with a minimum dynamic water pressure of 250kPa and a maximum of 1000kPa. |
| Pressure Valve | Integrated 500kPa pressure limiting and dual check valve is pre-installed to the unit inlet. |
| Stone Benches | Billi has a no-cut policy regarding all stone benches in compliance with regulations. The safety of our team and customers remains Billi's top priority. |
| Ventilation | The Eco requires some cupboard ventilation and adequate air space as well as an unobstructed clearance of at least 100mm on each side of the underbench unit. Insufficient ventilation will cause inefficient refrigeration system operation, increasing power usage and potential failure. |

Filtration – Most Recommended Replacement Filters

Billi range of premium filters utilize BWT's unique FibronX® technology, providing superior taste, water quality, filter life longevity and peace of mind when it comes to hygiene.

994051 - (5.0 micron)

Supplied standard.
Commercial & high volume sites.

994052 - (0.2 micron)

Fine filtration.
Residential or Critical Care sites.

*Drawings are for guidance during Specification, refer to Installation requirements for final install. All efforts are made to ensure Compliance & Certifications claims are current, however this is subject to change without notice. Billi assumes no liability or responsibility for out of date information.



Technical support

Book a service call

Filtration & service

Warranty registration

Please scan the QR code for all support information.

Billi Australia Pty Ltd

P 1800 812 321

W www.billi.com.au

Billi New Zealand Ltd

P 0800 636 0 636

W www.billi.co.nz